

# hCG URINE

In-built positive and negative controls

Inverness Medical

## TESTPACK™+Plus

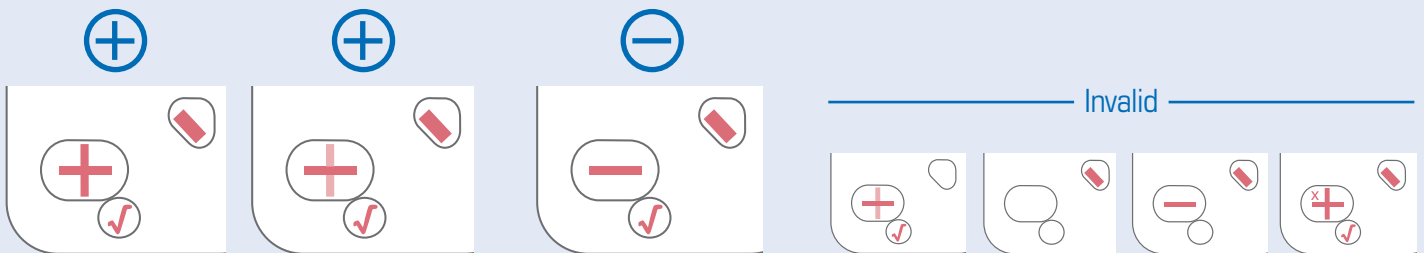
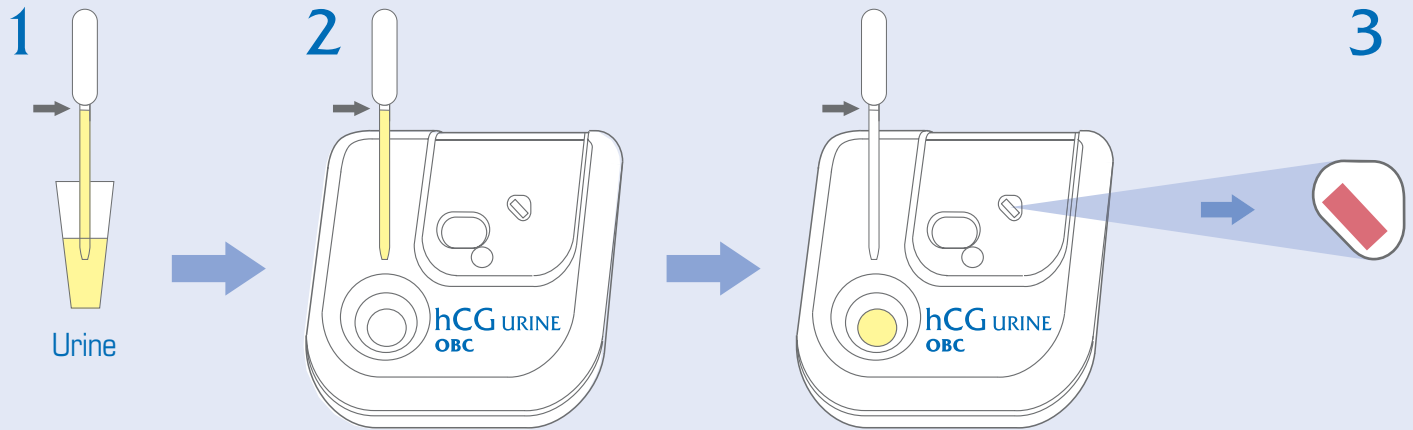

Immediately before use, remove test from foil pouch.

- 1 Draw urine sample to line marked on pipette.
- 2 Dispense ENTIRE CONTENTS of pipette drop-wise into sample well.
- 3 When End of Assay window changes to pink/red READ RESULTS IMMEDIATELY. Do not interpret results after this time.

## Assay Check

MUST BE present for valid test results



**The Minus Sign**  
A control showing that the sample has run through the test correctly.



**The Positive Control**  
Indicates the antibodies that detect hCG are working.



**End of Assay**  
Indicates the test is ready and must be read immediately.

MUST NOT be present



**The Negative Control**  
Indicates a non-specific entity in the sample that could cause a false positive result.

For a Positive Result



**The Patient Bar**  
Indicates the presence of hCG in the sample.